

10 SOLAR PANELS
Save up to 50% on your electricity bills annually*



2,087 Sq.Ft.

 **3** Bed

 **2.5** Bath

 **2** Car

REECE24

INQUIRE FOR PRICING

13052 212 STREET NW
EDMONTON, AB

B47-017-0051
Elevation AC

JAYMAN'S STANDARD INCLUSIONS

- Core Performance with 10 Solar Panels
- BuiltGreen Canada standard, with an EnerGuide Rating
- UV-C Ultraviolet Light Air Purification System
- High Efficiency Furnace with Merv 13 Filters & HRV Unit
- Navien-Brand Tankless Hot Water Heater
- Triple Pane Windows
- Smart Home Technology Solutions

ADDITIONAL FEATURES

- Select Fit & Finish™
- Professionally Designed Sante Fe Elevated Colour Palette
- Chimney Hood Fan with Built-In Microwave
- Upper Floor Central Bonus Room
- 4-Piece Primary Ensuite including Stand-Up Shower
- Convenient Side Entrance
- 3-Piece Rough-In Plumbing in Basement

MOVE INTO THIS HOME IN AS LITTLE AS 6 MONTHS



Renderings and images are representational only.

TO VIEW YOUR NEW DREAM HOME, CONTACT:

Kat Rudol, Area Sales Manager

587.404.0290 | trumpeter@Jayman.com | Jayman.com



LIFE READY FOR THE WAY YOU LIVE

\$21,000
IN ENERGY EFFICIENT
FEATURES INCLUDED!

MAIN FLOOR 990 Sq.Ft.

- Front Flex Room/Den
- Central Kitchen with Island Eating Bar
- Spacious Walk-Thru Pantry to Mud Room
- Bright Rear Dining Room & Great Room

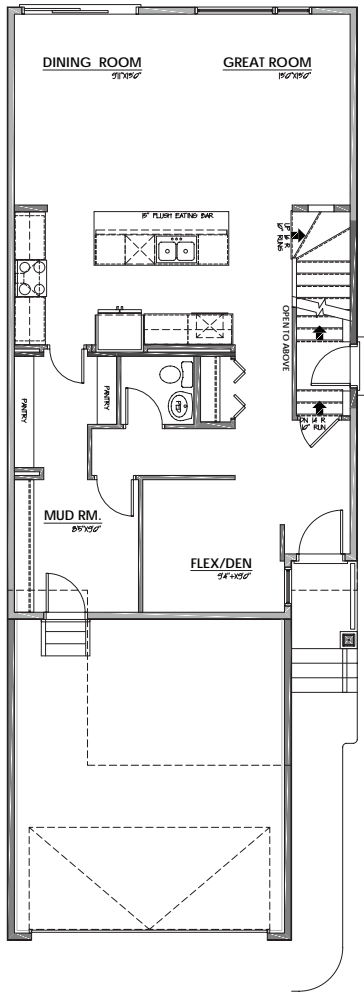

UPPER FLOOR 1,097 Sq.Ft.

- 4-Piece Primary Ensuite including Stand-Up Shower
- Primary Suite Walk-In Closet
- Central Bonus Room
- Laundry Room with Folding Counter

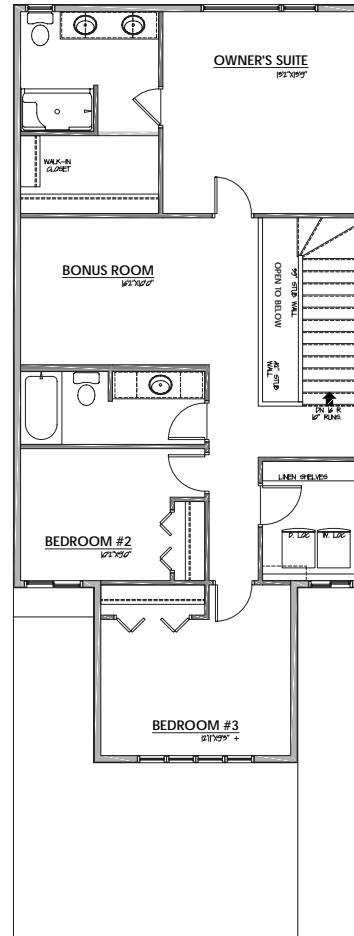

SANTE FE ELEVATED COLOUR PALETTE



IT'S EASIER THAN EVER TO JOIN THE JAYMAN FAMILY



JayLink by Jayman Realty

Secure the home you really want while Jayman Realty focuses on the sale of your existing home with a JayLink, or Jayman Realty's Resale Equity Action Plan. To simplify your move, Jayman Realty can make the purchase of your new home subject to the sale of your existing home. You will receive 48 hours notice if another party puts an offer on your new home.



Providing you the absolute BEST MORTGAGE

Buying a new home is one of the most important financial decisions you will make. Our mortgage professionals will guide you through the entire process, providing you with expert advice to find the best financing solution for your new Jayman BUILT home.

DISCOVER YOUR NEXT HOME AT [Jayman.com](https://www.jayman.com)

Reflects 2024 Fit & Finish™ specifications. Renderings and images are representational only. Specifications subject to change without notice. Products and colours may be discontinued or unavailable at time of construction and a substitution required. This document is intended for marketing purposes only and does not constitute part of the purchase agreement. E.&O.E *Electricity savings do not include administration and other associated fees. Build time estimated from the date of the firm sale.