

10 SOLAR PANELS
Save up to 50% on your electricity bills annually*



1,490 Sq.Ft.

 **3** Bed

 **2.5** Bath

BROOKLYN20

68 WOLF CREEK GARDENS SE
CALGARY, AB

L63-014-0029
Elevation WE

**MOVE INTO THIS
HOME IN AS LITTLE
AS 6 MONTHS**

JAYMAN'S STANDARD INCLUSIONS

- Core Performance with 10 Solar Panels
- BuiltGreen Canada standard, with an EnerGuide Rating
- UV-C Ultraviolet Light Air Purification System
- High Efficiency Furnace with Merv 13 Filters & HRV Unit
- Navien-Brand Tankless Hot Water Heater
- Triple Pane Windows
- Smart Home Technology Solutions

INQUIRE FOR PRICING

ADDITIONAL FEATURES

- Extra Fit & Finish™
- Professionally Designed Down to Earth Colour Palette
- Convenient Side Entrance
- Upgraded Gas Range in Kitchen
- Rear BBQ Gas Line
- Expanded Bedrooms
- Raised 9' Basement Ceiling Height & 3-Piece Rough-In Plumbing



Renderings and images are representational only.

TO VIEW YOUR NEW DREAM HOME, CONTACT:
Christina Caddel, Area Sales Manager
403.474.1277 | wolfwillowlaned@Jayman.com | Jayman.com



LIFE READY FOR THE WAY YOU LIVE

\$21,000
IN ENERGY EFFICIENT
FEATURES INCLUDED!

MAIN FLOOR 720 Sq.Ft.

- Bright Rear Kitchen with Island Eating Bar
- Spacious Pantry Closet
- Central Dining Room

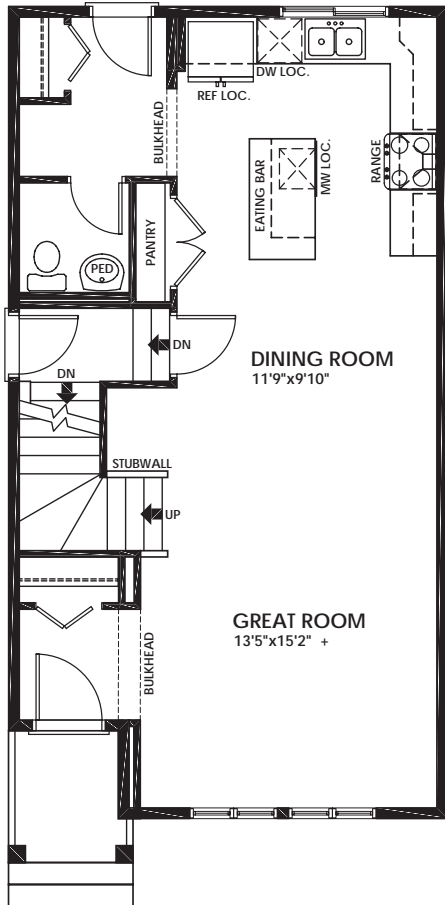

UPPER FLOOR 770 Sq.Ft.

- 3-Piece Primary Ensuite with Sliding Glass Door Shower
- Expanded Bedrooms
- Primary Suite Walk-In Closet
- Laundry & Linen Closets

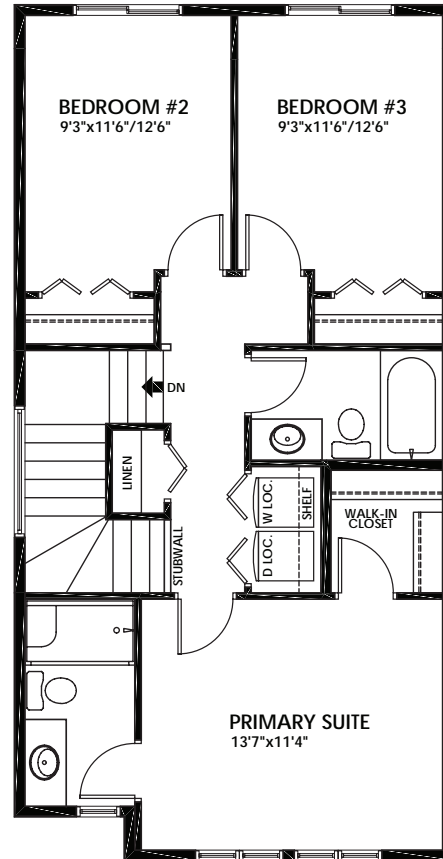

DOWN TO EARTH COLOUR PALETTE

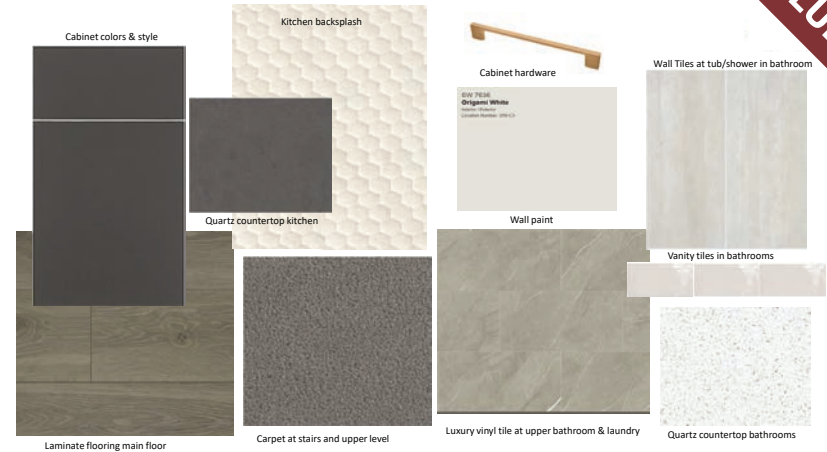

IT'S EASIER THAN EVER TO
JOIN THE **JAYMAN FAMILY**



JayLink by Jayman Realty

Secure the home you really want while Jayman Realty focuses on the sale of your existing home with a JayLink, or Jayman Realty's Resale Equity Action Plan. To simplify your move, Jayman Realty can make the purchase of your new home subject to the sale of your existing home. You will receive 48 hours notice if another party puts an offer on your new home.



Providing you the absolute **BEST MORTGAGE**

Buying a new home is one of the most important financial decisions you will make. Our mortgage professionals will guide you through the entire process, providing you with expert advice to find the best financing solution for your new Jayman BUILT home.

DISCOVER YOUR NEXT HOME AT [Jayman.com](https://www.jayman.com)

Reflects 2024 Fit & Finish™ specifications. Renderings and images are representational only. Specifications subject to change without notice. Products and colours may be discontinued or unavailable at time of construction and a substitution required. This document is intended for marketing purposes only and does not constitute part of the purchase agreement. E.&O.E *Electricity savings do not include administration and other associated fees. Build time estimated from the date of the firm sale.